

NYLON WEAR RING TECHNICAL INFORMATION

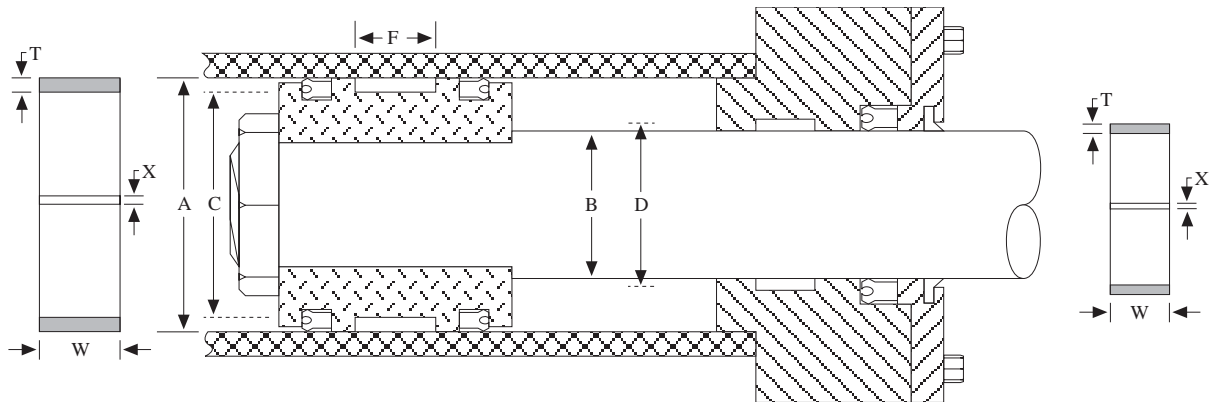

- A - Cylinder Bore
- B - Rod Diameter
- C - Minimum Bore "A" minus .253/.256
- D - Maximum Rod Diameter "B" plus .253/.256
- F - Groove Width
- T - Thickness of Wear Ring
- W - Width of Wear Ring
- X - Minimum Ring Gap

Groove Dimensions For Standard Wear Ring Widths

1/2" Width			5/8 Width			3/4" Width			1" Width		
E	I	X	E	I	X	E	I	X	E	I	X
.505"	.122"	1/16"	.630"	.122"	1/16"	.755"	.122"	1/16"	1.005"	.122"	1/16"
.510"	.125"		.635"	.125"		.760"	.125"		1.010"	.125"	

Cut Downs Factors For Standard Wear Rings

In many cases an oversized nylon wear ring can be cut down to fit a smaller groove without a loss of concentricity. Use the following guide when cutting down wear rings.

<u>Wear Ring O.D.</u>	<u>Maximum amount to be Cut Down</u>
4" OD	3/8" of circumference
4-1/2" - 6-1/2" OD	1/2"
7" -9" OD	1"
9-1/2" - 14" OD	1-1/2"

Flexible Guide Bearing Cut To Fit Formula

Use the following formula when cutting flexible guide bearing to fit a specific application.

For Piston Bearings
 Bearing Length = (Bore - C.S.) x 3.14 - Gap

For Rod Bearings
 Bearing Length = (Rod + C.S.) x 3.14 - Gap

FLEXIBLE GUIDE BEARINGS - FILLED PTFE

Flexible Guide Bearing are strips of filled PTFE. The material can be cut to any length to fit any rod or bore size without losing its concentricity. The filler material is shown below. NOTE: Glass filled material has a thickness tolerance of $\pm .010"$. Bronze filled tolerance is $\pm .0025"$.

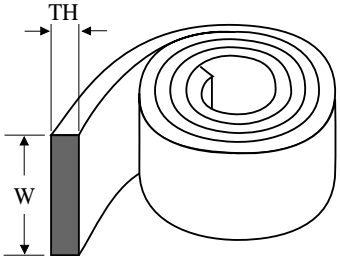

PART NUMBERS

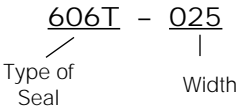

SEAL INFORMATION	
TEMPERATURE RANGE	Glass Filled PTFE -40° to +400° F 40% Bronze Filled PTFE -40° to +400° F
TENSILE STRENGTH	2,100 PSI
COMPRESSIVE STRENGTH	1,500 PSI

<u>Part Number</u>	<u>Width</u>	<u>Thick.</u>	<u>Filler</u>	<u>List Price</u>
606T-025.....	1/4	1/16	BRONZE	\$ 8.40
606T-050.....	1/2	1/16	BRONZE	9.45
606T-062.....	5/8	1/16	BRONZE	7.29
606T-075.....	3/4	1/16	BRONZE	10.45
606T-100.....	1	1/16	BRONZE	11.88
609T-075.....	3/4	3/32	BRONZE	11.03
609T-100.....	1	3/32	BRONZE	11.88
609T-125.....	1-1/4	3/32	BRONZE	18.90

<u>Part Number</u>	<u>Width</u>	<u>Thick.</u>	<u>Filler</u>	<u>List Price</u>
612T-037B	3/8	1/8	BRONZE	\$ 6.12
612T-050.....	1/2	1/8	GLASS	6.56
612T-050B	1/2	1/8	BRONZE	14.70
612T-062.....	5/8	1/8	GLASS	8.21
612T-062B	5/8	1/8	BRONZE	17.09
612T-075.....	3/4	1/8	GLASS	16.37
612T-075B	3/4	1/8	BRONZE	18.78
612T-100.....	1	1/8	GLASS	16.47
612T-100B	1	1/8	BRONZE	23.10
612T-112.....	1-1/8	1/8	GLASS	18.36
612T-150.....	1-1/2	1/8	GLASS	22.04

FLEXIBLE GUIDE BEARINGS - POLYESTER RESIN

Manufactured using woven fabric-reinforced polyester resin, this material produces a dimensionally accurate rectangular strip which can be cut to any length. Low co-efficient of friction and high compressive strength makes it an ideal bearing material. A common radial thickness of 1/8" allows the stacking of various widths. Size reference is marked every 6" on the strip. Available by the foot or in flat boxed rolls of 32 feet. Cutting is made easy by using Anvil type pruning shears. Wall tolerance $\pm .002"$, radial wall thickness = 0.124 to 0.121".

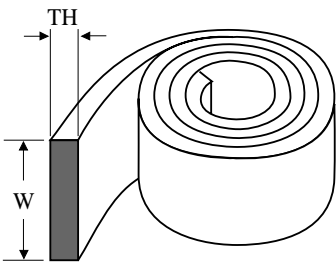

PART NUMBERS

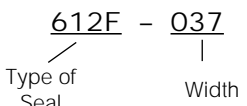

SEAL INFORMATION	
TEMPERATURE RANGE	-40° to +250° F
TENSILE STRENGTH	8,500 PSI
COMPRESSIVE STRENGTH	16,500 PSI

<u>Part Number</u>	<u>Width</u>	<u>Thickness</u>	<u>List Price</u>
612F-037	3/8	1/8	\$ 10.08
612F-050	1/2	1/8	10.51
612F-062	5/8	1/8	13.17
612F-075	3/4	1/8	17.49
612F-100	1	1/8	18.05

STYLE 606 NYLON WEAR RINGS 1/16" THICK

NOTE: SC suffix designates a Scarf Cut wear ring.

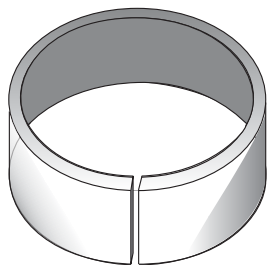

PART NUMBERS

606 - 162 - 125
 Type of Wear Ring O.D. Width

SEAL INFORMATION

TEMPERATURE RANGE	-40° to +250° F
TENSILE STRENGTH	27,000 PSI
COMPRESSIVE STRENGTH	35,000 PSI

Part Number	O.D.	Width	List Price	Part Number	O.D.	Width	List Price
606-087-050	7/8	1/2	\$ 6.73	606-262-168	2-5/8	1-11/16	\$ 28.27
606-112-050	1-1/8	1/2	4.13	606-275-098-SC	2-3/4	0.98	8.02
606-125-050-SC	1-1/4	1/2	7.67	606-275-100	2-3/4	1	11.83
606-137-050	1-3/8	1/2	5.39	606-287-100-SC	2-7/8	1	23.96
606-162-082	1-5/8	13/16	6.30	606-287-126-SC	2-7/8	1.260	25.56
606-162-098	1-5/8	.980	5.39	606-287-157-SC	2-7/8	1-9/16	28.00
606-162-125	1-5/8	1-1/4	11.31	606-287-181	2-7/8	1-13/16	18.20
606-187-098-SC	1-7/8	.980	33.61	606-312-098-SC	3-1/8	0.98	8.52
606-200-025	2	1/4	11.84	606-312-124	3-1/8	1.240	39.85
606-200-072	2	.720	13.43	606-312-156	3-1/8	1-9/16	44.17
606-200-098-SC	2	.980	17.64	606-312-165-SC	3-1/8	1.650	22.55
606-212-125	2-1/8	1-1/4	16.90	606-325-050	3-1/4	1/2	5.37
606-225-036	2-1/4	.360	28.03	606-337-168	3-3/8	1-11/16	29.68
606-225-072	2-1/4	.720	27.62	606-337-174	3-3/8	1.740	40.16
606-237-098-SC	2-3/8	.980	19.91	606-337-187	3-3/8	1-7/8	33.69
606-237-100	2-3/8	1	14.61	606-362-105	3-5/8	1.050	27.10
606-237-118	2-3/8	1-3/16	17.79	606-362-188	3-5/8	1-7/8	32.50
606-262-098	2-5/8	.980	19.33	606-387-157	3-7/8	1.570	44.46
606-262-125	2-5/8	1-1/4	22.14				

STYLE 608 NYLON WEAR RINGS .078" THICK

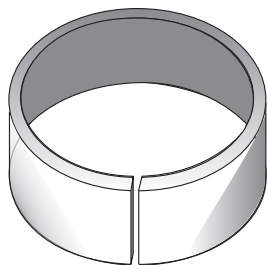

PART NUMBERS

608 - 125 - 050
 Type of Wear Ring O.D. Width

SEAL INFORMATION

TEMPERATURE RANGE	-40° to +250° F
TENSILE STRENGTH	27,000 PSI
COMPRESSIVE STRENGTH	35,000 PSI

Part Number	O.D.	Width	List Price
608-125-050	1-1/4	1/2	\$ 6.71
608-152-075	1.520	3/4	6.94
608-154-075	1.540	.078	6.94
608-166-062	1.66	.625	6.42

STYLE 609 NYLON WEAR RINGS 3/32" THICK

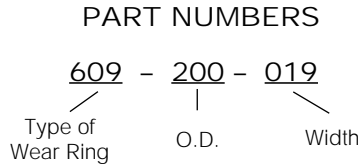
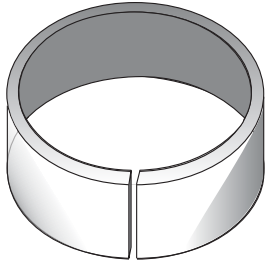

SEAL INFORMATION	
TEMPERATURE RANGE	-40° to +250° F
TENSILE STRENGTH	27,000 PSI
COMPRESSIVE STRENGTH	35,000 PSI

Part Number	O.D.	Width	List Price
609-125-018.....	1-1/4.....	3/16.....	\$ 2.06
609-150-018.....	1-1/2.....	3/16.....	2.54
609-150-037.....	1-1/2.....	3/8.....	6.95
609-200-019.....	2.....	3/16.....	2.54
609-200-037.....	2.....	3/8.....	7.28
609-250-037.....	2-1/2.....	3/8.....	7.39
609-255-150.....	2.55.....	1-1/2.....	4.24
609-285-100.....	2.85.....	1.....	4.46
609-300-022.....	3.....	7/32.....	1.93

Part Number	O.D.	Width	List Price
609-325-037.....	3-1/4.....	3/8.....	\$ 7.72
609-331-062.....	3-5/16.....	5/8.....	3.67
609-350-050.....	3-1/2.....	1/2.....	2.65
609-362-022.....	3-5/8.....	7/32.....	4.86
609-393-022.....	3-15/16.....	7/32.....	2.01
609-400-037.....	4.....	3/8.....	8.56
609-500-050.....	5.....	1/2.....	9.33
609-600-050.....	6.....	1/2.....	9.61

STYLE 610 NYLON WEAR RINGS .100" THICK

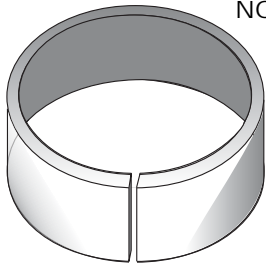

NOTE: SC suffix designates a Scarf Cut wear ring.

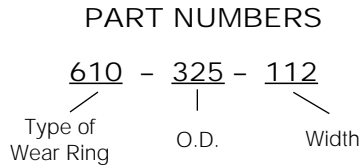

SEAL INFORMATION	
TEMPERATURE RANGE	-40° to +250° F
TENSILE STRENGTH	27,000 PSI
COMPRESSIVE STRENGTH	35,000 PSI

Part Number	O.D.	Width	List Price
610-270-228.....	2.70.....	2.28.....	\$ 42.04
610-295-196.....	2.95.....	1.96.....	35.31
610-300-099-SC.....	3.00.....	0.99.....	8.52
610-325-112.....	3.25.....	1-1/8.....	32.33
610-345-162.....	3.45.....	1-5/8.....	28.97
610-345-196.....	3.45.....	1.96.....	32.78
610-345-274.....	3.45.....	2.74.....	47.37
610-370-176.....	3.70.....	1.76.....	53.00
610-370-236.....	3.70.....	2.36.....	37.16
610-395-243.....	3.95.....	2-7/16.....	54.40

Part Number	O.D.	Width	List Price
610-420-156-SC.....	4.20.....	1-9/16.....	\$ 24.88
610-420-255.....	4.20.....	2.55.....	37.96
610-445-237.....	4.45.....	2-3/8.....	42.40
610-495-196.....	4.95.....	1.96.....	53.50
610-520-250.....	5.20.....	2-1/2.....	53.00
610-550-249-SC.....	5.50.....	2.490.....	55.56
610-595-361.....	5.95.....	3.61.....	80.25
610-720-314.....	7.20.....	3.140.....	71.75

STYLE 612 NYLON WEAR RINGS 1/8" THICK

Style 612 wear rings are made of glass reinforced nylon. With physical properties equivalent to bronze they are highly recommended because of their wear rate and non-scoring properties and their ability to ingest metal chips. NOTE: "SC" suffix designates a Scarf Cut wear ring, "ST" a Step Cut wear ring and "SL" Slots on the O.D..

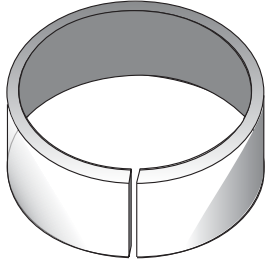

P = Precision Tolerance .123/.125 THK

PART NUMBERS

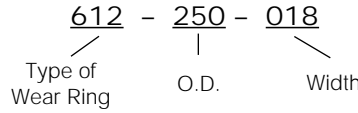

SEAL INFORMATION	
TEMPERATURE RANGE	-40° to +250° F
TENSILE STRENGTH	27,000 PSI
COMPRESSIVE STRENGTH	35,000 PSI

<u>Part Number</u>	<u>O.D.</u>	<u>List Price</u>
.160" WIDE		
612-200-016	2	\$ 5.61
612-250-016P	2-1/2	5.92
3/16" WIDE		
612-250-018	2-1/2	2.65
1/4" WIDE		
612-150-025	1-1/2	1.73
612-200-025	2	1.90
612-250-025	2-1/2	2.20
612-300-025	3	2.27
612-306-025	3-1/16	4.48
612-325-025	3-1/4	2.44
612-387-025	3-7/8	3.62
612-425-025	4-1/4	6.98
612-1000-025	10	42.55
.260" WIDE		
612-218-026	2-3/16	2.16
5/16" WIDE		
612-225-031	2-1/4	2.36
612-250-031	2-1/2	2.22
612-275-031	2-3/4	2.48
612-275-031P	2-3/4	4.24
612-300-031	3	2.44
612-400-031	4	7.89
3/8" WIDE		
612-100-037	1	2.22
612-112-037	1-1/8	2.22
612-125-037	1-1/4	2.22
612-150-037	1-1/2	2.22
612-175-037	1-3/4	2.24
612-200-037	2	2.24
612-212-037	2-1/8	2.36
612-225-037	2-1/4	2.36
612-250-037	2-1/2	2.44
612-275-037	2-3/4	2.48
612-300-037	3	2.53
612-325-037	3-1/4	2.58
612-350-037	3-1/2	2.60
612-375-037	3-3/4	2.65
612-375-037	3-3/4	7.09

<u>Part Number</u>	<u>O.D.</u>	<u>List Price</u>
3/8" WIDE		
612-400-037	4	\$ 3.30
612-425-037	4-1/4	3.39
612-450-037	4-1/2	3.44
612-500-037	5	3.55
612-550-037	5-1/2	2.78
612-600-037	6	4.01
.420" WIDE		
612-412-042	4-1/8	10.44
7/16" WIDE		
612-350-043	3-1/2	6.15
1/2" WIDE		
612-125-050	1-1/4	2.70
612-137-050	1-3/8	2.58
612-150-050	1-1/2	2.22
612-162-050	1-5/8	2.20
612-175-050	1-3/4	2.20
612-187-050	1-7/8	2.31
612-200-050	2	2.36
612-200-050-ST	2	5.44
612-212-050	2-1/8	2.68
612-225-050	2-1/4	2.36
612-225-050-SC	2-1/4	4.20
612-237-050	2-3/8	2.44
612-250-050	2-1/2	2.46
612-250-050-ST	2-1/2	4.08
612-262-050	2-5/8	4.24
612-275-050	2-3/4	2.48
612-287-050	2-7/8	3.05
612-300-050	3	2.53
612-300-050P	3	6.28
612-300-050P-SC	3	9.65
612-312-050	3-1/8	2.58
612-325-050	3-1/4	2.58
612-350-050	3-1/2	2.60
612-375-050	3-3/4	2.65
612-375-050P-SC	3-3/4	7.09
612-375-050-ST	3-3/4	11.84
612-400-050	4	2.65

STYLE 612 NYLON WEAR RINGS 1/8" THICK

WEAR RINGS

Part Number	O.D.	List Price
1/2" WIDE		
612-425-050	4-1/4	\$ 2.72
612-426-050	4.260	8.22
612-450-050	4-1/2	2.78
612-475-050	4-3/4	2.78
612-500-050	5	2.78
612-525-050	5-1/4	2.78
612-525-050P	5-1/4	6.23
612-550-050	5-1/2	2.78
612-550-050P	5-1/2	11.62
612-575-050	5-3/4	3.18
612-600-050	6	3.18
612-600-050P-SC	6	5.77
612-625-050	6-1/4	3.66
612-650-050	6-1/2	3.66
612-700-050	7	3.66
612-725-050	7-1/4	6.53
612-750-050	7-1/2	3.66
612-775-050	7-3/4	13.28
612-800-050	8	3.96
612-850-050	8-1/2	4.39
612-862-050	8-5/8	6.55
612-900-050	9	7.03
612-950-050	9-1/2	7.35
612-975-050	9-3/4	7.51
612-987-050	9-7/8	12.32
612-1000-050	10	12.32
612-1050-050	10-1/2	18.92
612-1100-050	11	35.09
612-1200-050	12	21.42
612-1400-050	14	154.42
612-1600-050	16	176.46
612-1800-050	18	159.12
612-2000-050	20	220.61
5/8" WIDE		
612-150-062	1-1/2	2.22
612-200-062	2	2.41
612-225-062	2-1/4	2.48
612-250-062	2-1/2	2.63
612-262-062	2-5/8	2.68
612-275-062	2-3/4	2.68
612-300-062	3	2.68
612-325-062	3-1/4	2.82
612-350-062	3-1/2	2.88
612-350-062-ST	3-1/2	4.11
612-362-062	3-5/8	4.55
612-375-062	3-3/4	2.98
612-400-062	4	3.10
612-400-062-ST	4	3.10
612-425-062	4-1/4	3.10
612-440-062	4.40	3.10
612-450-062	4-1/2	3.10

Part Number	O.D.	List Price
5/8" WIDE		
612-500-062	5	\$ 3.10
612-525-062	5-1/4	3.10
612-550-062	5-1/2	3.29
612-575-062	5-3/4	3.39
612-600-062	6	3.39
612-600-062-SC	6	12.15
612-625-062	6-1/4	3.42
612-650-062	6-1/2	3.66
612-700-062	7	3.66
612-700-062-SC	7	6.92
612-725-062	7-1/4	8.16
612-750-062	7-1/2	4.26
612-800-062	8	8.16
612-850-062	8-1/2	6.27
612-900-062	9	6.60
612-950-062	9-1/2	7.45
612-1000-062	10	19.11
3/4" WIDE		
612-175-075	1-3/4	2.81
612-187-075	1-7/8	2.47
612-200-075	2	2.52
612-212-075	2-1/8	2.41
612-225-075	2-1/4	2.44
612-225-075-SC	2-1/4	4.37
612-237-075	2-3/8	2.92
612-250-075	2-1/2	2.92
612-262-075	2-5/8	2.99
612-275-075	2-3/4	3.04
612-300-075	3	2.88
612-325-075	3-1/4	2.88
612-337-075	3-3/8	2.88
612-350-075	3-1/2	2.90
612-362-075	3-5/8	2.90
612-375-075	3-3/4	3.04
612-400-075	4	2.90
612-425-075	4-1/4	3.21
612-450-075	4-1/2	3.03
612-450-075P	4-1/2	5.56
612-450-075-SC	4-1/2	5.56
612-475-075	4-3/4	3.10
612-487-075	4-7/8	5.10
612-500-075	5	3.10
612-525-075	5-1/4	3.17
612-550-075	5-1/2	3.17
612-575-075	5-3/4	4.08
612-600-075	6	3.29
612-650-075	6-1/2	3.66
612-675-075	6-3/4	4.18
612-700-075	7	4.18
612-750-075	7-1/2	4.26
612-800-075	8	5.62

STYLE 612 NYLON WEAR RINGS 1/8" THICK

Part Number	O.D.	List Price
3/4" WIDE		
612-850-075	8-1/2	\$ 7.73
612-900-075	9	8.03
612-950-075	9-1/2	11.71
612-975-075	9-3/4	12.80
612-1000-075	10	12.80
612-1150-075	11-1/2	28.06
612-1250-075	12-1/2	101.32
612-1350-075	13-1/2	150.28
7/8" WIDE		
612-225-087	2-1/4	4.42
612-250-087	2-1/2	4.68
612-287-087	2-7/8	8.61
612-350-087	3-1/2	5.99
612-400-087	4	6.11
612-425-087P	4-1/4	14.16
612-450-087	4-1/2	7.17
612-600-087	6	8.65
612-800-087	8	16.73
15/16" WIDE		
612-275-093	2-3/4	7.60
612-450-093	4-1/2	9.42
1" WIDE		
612-150-100	1-1/2	5.14
612-175-100	1-3/4	3.24
612-200-100	2	4.35
612-225-100	2-1/4	6.01
612-250-100	2-1/2	3.24
612-250-100-ST	2-1/2	5.78
612-262-100	2-5/8	7.99
612-275-100	2-3/4	3.19
612-275-100-SC	2-3/4	7.43
612-275-100-ST	2-3/4	10.98
612-287-100	2-7/8	3.21
612-300-100	3	2.81
612-300-100-ST	3	4.69
612-325-100	3-1/4	3.10
612-325-100-SC	3-1/4	5.49
612-350-100	3-1/2	3.16
612-350-100-SL	3-1/2	6.23
612-350-100-ST	3-1/2	9.30
612-362-100	3-5/8	10.42
612-375-100	3-3/4	3.18
612-375-100P-SC	3-3/4	8.73
612-400-100	4	3.40
612-400-100P-SC	4	16.79
612-400-100-SL	4	24.77
612-425-100	4-1/4	4.16
612-450-100	4-1/2	4.16
612-475-100	4-3/4	4.18
612-500-100	5	4.18
612-525-100	5-1/4	4.50

Part Number	O.D.	List Price
1" WIDE		
612-550-100	5-1/2	\$ 4.24
612-575-100	5-3/4	4.30
612-600-100	6	4.30
612-625-100	6-1/4	4.36
612-650-100	6-1/2	4.65
612-675-100	6-3/4	5.95
612-700-100	7	6.23
612-725-100	7-1/4	9.60
612-750-100	7-1/2	9.60
612-787-100	7-7/8	21.10
612-800-100	8	9.60
612-825-100	8-1/4	10.27
612-875-100	8-3/4	19.78
612-900-100	9	13.15
612-1000-100	10	14.10
612-1025-100	10-1/4	11.00
612-1050-100	10-1/2	37.69
612-1100-100	11	37.23
612-1200-100	12	36.65
612-1225-100	12-1/4	95.21
612-1400-100	14	76.77
612-1600-100	16	74.60
612-1650-100	16-1/2	160.94
1.02" WIDE		
612-525-102	5-1/4	23.90
1-1/16" WIDE		
612-600-107	6	20.49
1.11" WIDE		
612-325-111	3-1/4	10.09
1-1/8" WIDE		
612-350-112	3-1/2	8.22
612-500-112	5	10.57
1.24" WIDE		
612-300-124-SC	3	13.09
612-375-124	3-3/4	9.06
612-500-124	5	22.50
1-1/4" WIDE		
612-325-125	3-1/4	11.55
612-375-125	3-3/4	11.59
612-375-125P-SC	3-3/4	11.59
612-400-125	4	7.68
612-425-125	4-1/4	8.47
612-425-125-SC	4-1/4	7.41
612-475-125	4-3/4	12.41
612-475-125-SC	4-3/4	7.75
612-525-125	5-1/4	18.56
612-550-125	5-1/2	11.85
612-600-125	6	15.46
612-676-125P-SC	6.756	23.58

STYLE 612 NYLON WEAR RINGS 1/8" THICK

WEAR RINGS

Part Number	O.D.	List Price
1-1/4" WIDE		
612-650-125	6-1/2	\$ 16.62
612-825-125	8-1/4	17.24
612-1000-125	10	18.63
612-1025-125-SC	10-1/4	54.29
612-1050-125	10-1/2	85.85
612-1100-125	11	40.45
612-1125-125	11-1/4	63.46
612-1200-125	12	66.69
612-1225-125	12-1/4	98.43
612-1400-125	14	191.14
1-5/16" WIDE		
612-600-131	6	17.7
1-3/8" WIDE		
612-550-137	5-1/2	22.89
612-650-137	6-1/2	15.06
1.38" WIDE		
612-725-138	7-1/4	33.15
1.46" WIDE		
612-800-146-ST	8	29.86
1.49" WIDE		
612-375-149	3-3/4	16.76
612-425-149	4-1/4	11.30
612-525-149	5-1/4	14.62
612-625-149	6-1/4	19.54
612-625-149-SC	6-1/4	18.12
612-750-149-SC	7-1/2	26.07
1-1/2" WIDE		
612-200-150	2	8.98
612-275-150	2-3/4	8.99
612-325-150P	3-1/4	8.99
612-350-150	3-1/2	9.00
612-400-150	4	18.87
612-425-150P	4-1/4	16.04
612-450-150	4-1/2	13.02
612-600-150	6	18.12
612-600-150-ST	6	23.98
612-625-150	6-1/4	14.83
612-650-150	6-1/2	15.42
612-675-150P	6-3/4	14.95
612-700-150	7	7.57
612-825-150	8-1/4	23.25
612-900-150	9	71.54
612-1000-150	10	37.52
612-1200-150	12	70.65
612-1300-150	13	181.11
612-1400-150	14	127.71
612-1600-150	16	188.13

Part Number	O.D.	List Price
1.55" WIDE		
612-325-155	3-1/4	\$ 12.52
612-500-155	5	11.14
1-9/16" WIDE		
612-475-156	4-3/4	10.04
612-512-156	5-1/8	13.26
612-512-156-SC	5-1/8	13.26
1.61" WIDE		
612-550-161	5-1/2	29.13
1-5/8" WIDE		
612-325-162-SC	3-1/4	11.22
612-1100-162	11	90.67
1.74" WIDE		
612-650-174	6-1/2	30.14
612-700-174	7	30.21
1-3/4" WIDE		
612-500-175	5	56.95
612-550-175	5-1/2	16.00
612-575-175	5-3/4	29.88
612-600-175	6	29.88
612-625-175	6-1/4	30.27
612-825-175	8-1/4	30.56
1.86" WIDE		
612-450-186	4-1/2	21.13
1-7/8" WIDE		
612-1100-187	11	114.84
1.88" WIDE		
612-425-188	4-1/4	16.04
1.99" WIDE		
612-375-199	3-3/4	23.91
612-475-199	4-3/4	37.85
612-550-199	5-1/2	32.13
612-575-199	5-3/4	36.66
612-700-199	7.000	32.03
612-725-199	7-1/4	33.23
612-775-199	7-3/4	35.04
2" WIDE		
612-325-200	3-1/4	14.79
612-325-200P-SC	3-1/4	14.79
612-475-200	4-3/4	20.62
612-525-200-SC	5-1/4	22.95
612-600-200	6	50.94
612-625-200	6-1/4	24.43
612-625-200-SC	6-1/4	15.53
612-650-200	6-1/2	28.65
612-700-200	7	28.65
612-725-200	7-1/4	33.23

STYLE 612 NYLON WEAR RINGS 1/8" THICK

Part Number	O.D.	List Price	Part Number	O.D.	List Price
2" WIDE			2.95" WIDE		
612-725-200-SC	7-1/4	\$ 33.23	612-750-295	7-1/2	\$ 122.42
612-750-200	7-1/2	28.34	3" WIDE		
612-800-200	8	43.97	612-700-300	7	77.60
612-850-200	8-1/2	32.58	612-850-300	8-1/2	76.58
612-1200-200	12	77.52	3-1/8" WIDE		
2-1/8" WIDE			612-700-312	7	52.98
612-325-212-SC	3-1/4	15.29	3-1/4" WIDE		
612-825-212	8-1/4	46.41	612-1000-325	10	60.62
2.24" WIDE			3-1/2" WIDE		
612-550-224	5-1/2	37.72	612-475-350	4-3/4	36.34
2-1/4" WIDE			612-775-350	7-3/4	79.47
612-825-225	8-1/4	49.61	3.61" WIDE		
612-925-225	9-1/4	76.34	612-525-361	5-1/4	73.70
2.36" WIDE			3.74" WIDE		
612-450-236	4-1/2	35.19	612-1050-374-SC	10-1/2	60.86
612-575-236	5-3/4	50.20	3-3/4" WIDE		
612-750-236	7-1/2	48.26	612-1050-375	10-1/2	84.39
612-850-236	8-1/2	67.12	3-7/8" WIDE		
2-3/8" WIDE			612-1150-387	11-1/2	66.78
612-850-237	8-1/2	38.92	3.99" WIDE		
2.49" WIDE			612-1425-399	14-1/4	237.86
612-426-249	4.26	31.05	4" WIDE		
612-825-249	8-1/4	76.27	612-1050-400	10-1/2	91.30
2-1/2" WIDE			4.11" WIDE		
612-750-250	7-1/2	47.03	612-825-411	8-1/4	131.81
2.74" WIDE			5" WIDE		
612-625-274-SC	6-1/4	84.04	612-800-500	8	74.53
612-650-274	6-1/2	64.90	7.10" WIDE		
612-825-274	8-1/4	61.52	612-725-710	7-1/4	155.44
612-1050-274	10-1/2	102.85			
2.86" WIDE					
612-600-286	6	62.63			
612-650-286	6-1/2	41.50			

STYLE 616 NYLON WEAR RINGS 3/16" THICK

WEAR RINGS

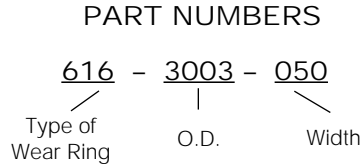
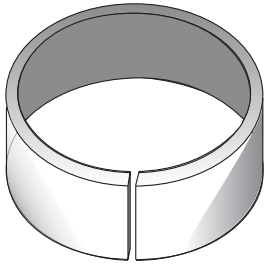

SEAL INFORMATION	
TEMPERATURE RANGE	-40° to +250° F
TENSILE STRENGTH	27,000 PSI
COMPRESSIVE STRENGTH	35,000 PSI

<u>Part Number</u>	<u>O.D.</u>	<u>List Price</u>
1/2" WIDE		
616-3003-050	3	\$ 8.97
616-3503-050	3-1/2	10.15
616-4003-050	4	10.34
616-4503-050	4-1/2	12.72
616-9875-050	9-7/8	52.94
5/8" WIDE		
616-2203-062	2.200	6.83
616-2623-062	2-5/8	8.97
616-2873-062	2-7/8	6.50
616-3063-062	3-1/16	8.30
616-3253-062	3-1/4	14.92
616-6003-062	6	14.10
3/4" WIDE		
616-3003-075	3	6.88
616-3503-075	3-1/2	8.37
616-4253-075	4-1/4	9.20
616-5123-075	5-1/8	18.83
616-6123-075	6-1/8	21.30
616-6503-075	6-1/2	30.44
7/8" WIDE		
616-3003-087	3	8.26
616-4003-087	4	8.72
616-5003-087	5	10.21
616-5503-087	5-1/2	16.85
616-6003-087	6	18.05
616-7123-087	7-1/8	36.51
61/64" WIDE		
616-6123-095	6-1/8	32.21
1" WIDE		
616-3123-100	3-1/8	15.37
616-3503-100	3-1/2	15.23
616-3753-100	3-3/4	18.97
616-4003-100	4	18.97
616-4123-100	4-1/8	19.15
616-4503-100	4-1/2	20.16
616-5003-100	5	16.80
616-5503-100	5-1/2	22.90
616-5753-100	5-3/4	27.55
616-6003-100	6	26.25

<u>Part Number</u>	<u>O.D.</u>	<u>List Price</u>
1" WIDE		
616-6753-100	6-3/4	\$ 27.81
616-7123-100	7-1/8	29.55
616-7253-100	7-1/4	29.55
616-14003-100	14	178.67
1-1/4" WIDE		
616-3123-125	3-1/8	26.65
616-3373-125	3-3/8	29.86
616-3873-125	3-7/8	14.56
616-6003-125	6	17.38
616-7003-125	7	21.44
616-10003-125	10	47.11
1-1/2" WIDE		
616-1813-150	1-7/8	15.35
616-4373-150	4-3/8	17.81
616-5003-150	5	17.65
616-5503-150	5-1/2	24.57
616-6503-150	6-1/2	29.27
616-10003-150	10	90.90
1.61" WIDE		
616-7373-161	7-3/8	61.00
1.74" WIDE		
616-5503-174	5-1/2	35.94
1-3/4" WIDE		
616-3873-175	3-7/8	26.18
616-4373-175	4-3/8	40.21
616-5503-175	5-1/2	35.56
1.93" WIDE		
616-9503-193	9-1/2	104.31
1.99" WIDE		
616-8253-199	8-1/4	74.78
2-1/4" WIDE		
616-4875-225	4-7/8	41.50
2-1/2" WIDE		
616-12003-250	12	\$ 96.28
2.62" WIDE		
616-3873-262	3-7/8	45.44

STYLE 616 NYLON WEAR RINGS 3/16" THICK

Part Number	O.D.	List Price	Part Number	O.D.	List Price
2.74" WIDE					
616-6003-2746\$ 83.09	616-7753-4497-3/4\$ 157.89
616-8253-2748-1/4103.14			
2.89" WIDE					
616-12873-28912-7/8220.37	616-15123-77115-1/8717.07
3-1/16" WIDE					
616-7253-3067-1/490.93	616-12873-121812-7/8958.03
4" WIDE					
616-12253-40012-1/4204.53			

STYLE 617 PHENOLIC WEAR RINGS 1/8" THICK

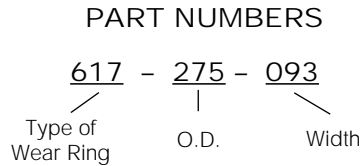
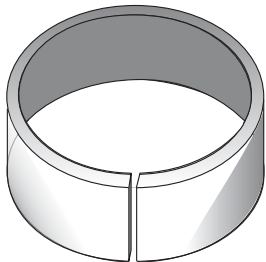

SEAL INFORMATION	
TEMPERATURE RANGE	-40° to +250° F
TENSILE STRENGTH	10,600 PSI
COMPRESSIVE STRENGTH	34,000 PSI

Part Number	O.D.	Width	List Price
617-300-11931.190\$ 20.18
617-400-13841.38530.33
617-925-1759-1/41-3/418.77

STYLE 614 NYLON ROD BEARINGS

Style 614 rod bearings are available in nylon material. These products are used extensively in hydraulic cylinders due to their low rate of wear and non-scoring properties. Excellent for those heavy duty applications that require a sturdy bearing. Most of these bearings are solid, although some may be split. NOTE: Items marked with * are split

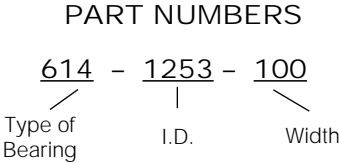
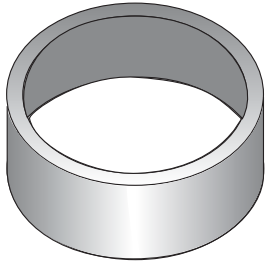

SEAL INFORMATION	
TEMPERATURE RANGE	-40° to +250° F
TENSILE STRENGTH	27,000 PSI
COMPRESSIVE STRENGTH	35,000 PSI

Part Number	I.D.	O.D.	Width	List Price
614-1253-100	1-1/4	1-1/2	1	\$ 7.50
614-1254-084	1-1/4	1-3/4	27/32	7.89
614-1254-100	1-1/4	1-3/4	1	7.30
614-1255-150	1-1/4	1-7/8	1-1/2	12.00
614-1502-100	1-1/2	1-5/8	.975	3.34
614-1503-100	1-1/2	1-3/4	1	3.41
614-1504-058	1-1/2	2	.580	3.41
614-1504-075	1-1/2	2	3/4	5.60
614-1505-150	1-1/2	2-1/8	1-1/2	18.35
614-1752-100	1-3/4	1-7/8	.975	3.40
614-1753-100	1-3/4	2	1	3.62
614-1754-040	1-3/4	2-1/4	7/16	3.81
614-1754-058	1-3/4	2-1/4	.580	3.89
614-1754-075	1-3/4	2-1/4	3/4	5.30
614-1754-087	1-3/4	2-1/4	7/8	19.88
614-2002-100	2	2-1/8	.975	3.54
614-2003-099	2	2-1/4	1	3.73
614-2004-050	2	2-1/2	1/2	5.84
614-2004-058	2	2-1/2	.580	4.31
614-2004-070	2	2-1/2	.700	24.38
614-2004-075	2	2-1/2	3/4	5.74
614-2004-100	2	2-1/2	1	9.29
614-2252-150	2-1/4	2-3/8	1.475	7.12
614-2253-125	2-1/4	2-1/2	1-1/4	4.74
614-2253-155	2-1/4	2-1/2	1-35/64	5.66
614-2253-225	2-1/4	2-1/2	2-1/4	6.74
614-2254-058	2-1/4	2-3/4	.580	6.01
614-2254-075	2-1/4	2-3/4	3/4	5.78
614-2502-150	2-1/2	2-5/8	1.475	6.34
614-2503-125	2-1/2	2-3/4	1-1/4	4.54
614-2503-155	2-1/2	2-3/4	1-35/64	6.32
614-2504-025	2-1/2	3	1/4	4.91
614-2504-040	2-1/2	3	13/32	2.40
614-2504-058	2-1/2	3	.580	3.96
614-2504-075	2-1/2	3	3/4	5.99
614-2504-100	2-1/2	3	1	19.09
614-2753-155	2-3/4	3	1-35/64	10.52
614-2754-100	2-3/4	3-1/4	1	11.28
614-2755-100	2-3/4	3-3/8	1	10.93
614-3002-150	3	3-1/8	1.475	7.61

Part Number	I.D.	O.D.	Width	List Price
614-3004-046	3	3-1/2	15/32	\$ 4.46
614-3004-050	3	3-1/2	1/2	4.59
614-3004-058	3	3-1/2	.580	4.59
614-3004-075	3	3-1/2	3/4	6.61
614-3004-100	3	3-1/2	1	9.52
614-3004-150	3	3-1/2	1-1/2	12.33
614-3123-075	3-1/8	3-1/2	3/4	10.04
614-3123-084	3-1/8	3-1/2	.845	10.22
614-3253-155	3-1/4	3-1/2	1-35/64	6.54
614-3504-025	3-1/2	4	1/4	3.57
614-3504-046	3-1/2	4	15/32	4.13
614-3754-075	3-3/4	4-1/4	3/4	30.32
614-3754-100	3-3/4	4-1/4	1	12.01
614-3755-100	3-3/4	4-3/8	1	10.96
614-4004-025	4	4-1/2	1/4	3.62
614-4004-037	4	4-1/2	3/8	5.97
614-4004-075	4	4-1/2	3/4	6.61
614-4004-084	4	4-1/2	.845	12.02
614-4004-093	4	4-1/2	15/16	16.92
614-4004-100	4	4-1/2	1	10.22
614-4004-150	4	4-1/2	1-1/2	12.68
614-4504-025	4-1/2	5	1/4	5.04
614-4754-100	4-3/4	5-1/4	1	12.96
614-4755-100	4-3/4	5-3/8	1	16.81
614-5004-075	5	5-1/2	3/4	6.95
614-5004-084	5	5-1/2	.845	15.03
614-5004-093	5	5-1/2	15/16	17.50
614-5004-100	5	5-1/2	1	12.65
614-5754-100	5-3/4	6-1/4	1	13.69
614-5755-100	5-3/4	6-3/8	1	19.32
614-6004-037	6	6-1/2	3/8	4.64
614-6004-075	6	6-1/2	3/4	8.23
614-6004-084	6	6-1/2	.845	13.36
614-6004-093	6	6-1/2	15/16	18.38
614-6004-100	6	6-1/2	1	13.36
614-7004-075	7	7-1/2	3/4	8.95
614-8004-075	8	8-1/2	3/4	10.84
614-8256-075	8-1/4	9	3/4	20.53
614-9006-075	9	9-3/4	3/4	34.80
614-9375-100	9-3/8	10	1	66.47

STYLE 615 PHENOLIC BEARINGS

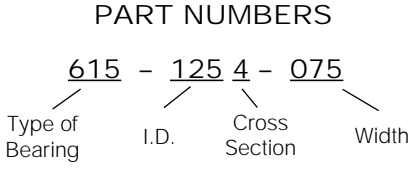
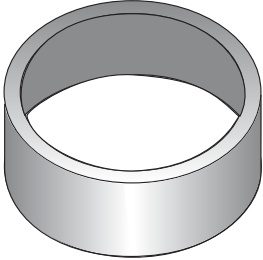

SEAL INFORMATION	
TEMPERATURE RANGE	-40° to +250° F
TENSILE STRENGTH	10,600 PSI
COMPRESSIVE STRENGTH	34,000 PSI

<u>Part Number</u>	<u>I.D.</u>	<u>O.D.</u>	<u>Width</u>	<u>List Price</u>
615-1254-075.....	1-1/4.....	1-3/4.....	3/4.....	\$ 2.61
615-1504-075.....	1-1/2.....	2.....	3/4.....	3.05
615-2504-150.....	2-1/2.....	3.....	1-1/2.....	10.66
615-2753-138.....	2-3/4.....	3.....	1.385.....	17.30
615-3753-175.....	3-3/4.....	4.....	1.74.....	32.09

STYLE 625 NYLON WEAR RINGS 1/4" THICK

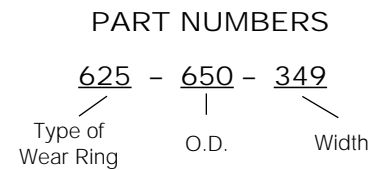
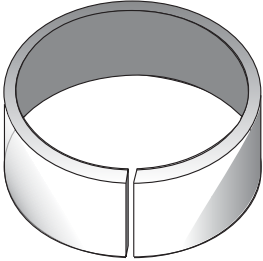

SEAL INFORMATION	
TEMPERATURE RANGE	-40° to +250° F
TENSILE STRENGTH	27,000 PSI
COMPRESSIVE STRENGTH	35,000 PSI

<u>Part Number</u>	<u>O.D.</u>	<u>Width</u>	<u>List Price</u>
625-650-349.....	6-1/2.....	3.49.....	\$ 110.25
625-650-350.....	6-1/2.....	3-1/2.....	83.62
625-825-350.....	8-1/4.....	3-1/2.....	103.88

STYLE 660 BRONZE ROD BEARINGS

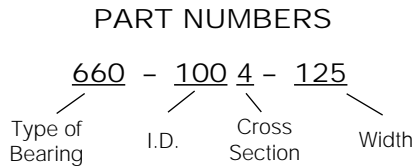
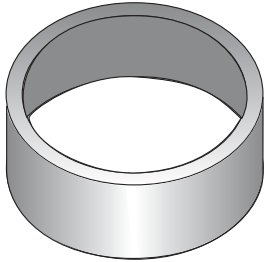

SEAL INFORMATION	
TEMPERATURE RANGE	-40° to +250° F
TENSILE STRENGTH	35,000 PSI
YIELD STRENGTH	18,000 PSI

<u>Part Number</u>	<u>I.D.</u>	<u>O.D.</u>	<u>Width</u>	<u>List Price</u>
660-1004-125.....11-1/41-1/4	\$ 19.91
660-1008-125.....11-1/21-1/4	24.50

MODULAR BACK-UPS

NOTE: These back-up rings, made from urethane or nylon, are commonly used as spacers for u-seals.

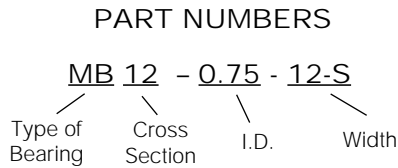
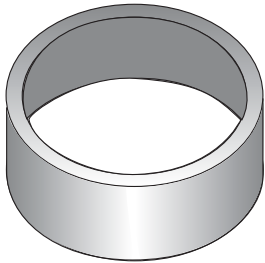

SEAL INFORMATION	
MATERIAL	URETHANE OR NYLON
TEMPERATURE RANGE	-40° TO +250° F

S = Split
P = Hard Hytrel

<u>Part Number</u>	<u>I.D.</u>	<u>O.D.</u>	<u>Width</u>	<u>List Price</u>
MB12-0.75-12-S.....3/411/8	\$ 3.24
MB18-2.00-18.....22-3/83/16	5.15
MB25-1.25-25.....1-1/41-3/41/4	5.15
MB25-1.37-25.....1-3/81-7/81/4	5.64
MB25-1.50-25.....1-1/221/4	5.04
MB25-1.75-25.....1-3/42-1/41/4	6.20
MB25-2.00-25.....22-1/21/4	6.72
MB25-2.50-25.....2-1/231/4	8.20
MB25-3.00-25.....33-1/21/4	8.32
MB25-3.25-25.....3-1/43-3/41/4	8.79
MB25-3.50-25.....3-1/241/4	8.79
MB25-4.00-25.....44-1/21/4	11.73
MB25-4.50-25.....4-1/251/4	13.47
MB25-5.00-25.....55-1/21/4	13.65
MB25-6.00-25.....66-1/21/4	19.25
MB31-1.75-31.....1-3/42-3/85/16	5.79
MB31-1.87-31.....1-7/82-1/25/16	6.93
MB31-2.00-31.....22-5/85/16	6.49
MB31-2.12-31.....2-1/82-3/45/16	6.81
MB31-2.25-31.....2-1/42-7/85/16	7.12
MB31-2.37-31.....2-3/835/16	9.24
MB31-2.50-31.....2-1/23-1/85/16	10.19
MB31-4.50-31.....4-1/25-1/85/16	15.59
MB31-5.00-31.....55-5/85/16	19.83
MB37-1.75-50.....1-3/42-1/21/2	10.95

<u>Part Number</u>	<u>I.D.</u>	<u>O.D.</u>	<u>Width</u>	<u>List Price</u>
MB37-1.75-56.....1-3/42-1/29/16	\$ 10.95
MB37-2.00-25P.....22-3/41/4	22.64
MB37-2.00-37.....22-3/43/8	11.35
MB37-2.62-50.....2-5/83-3/81/2	15.82
MB37-2.62-57.....2-5/83-3/85/8	15.82
MB37-2.75-25.....2-3/43-1/21/4	11.66
MB37-2.75-25P.....2-3/43-1/21/4	20.24
MB37-3.00-37.....33-3/43/8	13.61
MB37-3.12-37.....3-1/83-7/83/8	15.82
MB37-3.50-25.....3-1/24-1/41/4	16.80
MB37-3.50-37.....3-1/24-1/43/8	19.49
MB37-3.50-44P.....3-1/24-1/47/16	36.40
MB37-3.62-56.....3-5/84-3/89/16	20.99
MB37-4.00-37.....44-3/43/8	23.19
MB37-4.25-37.....4-1/453/8	23.68
MB37-4.50-50.....4-1/25-1/41/2	25.22
MB37-4.75-37.....4-3/45-1/23/8	27.12
MB37-5.00-37.....55-3/43/8	28.38
MB37-5.50-37.....5-1/26-1/43/8	30.26
MB37-6.00-56.....66-3/49/16	32.31
MB37-7.00-37.....77-3/43/8	34.78
MB37-8.25-37.....8-1/493/8	58.93
MB43-3.87-25.....3-7/84-3/41/4	8.90
MB43-4.50-62.....4-1/25-3/85/8	23.54
MB43-4.75-31.....4-3/45-5/85/16	18.55
MB50-3.50-50.....3-1/24-1/21/2	22.76